

Apartment 42

One bedroom apartment

Not to scale

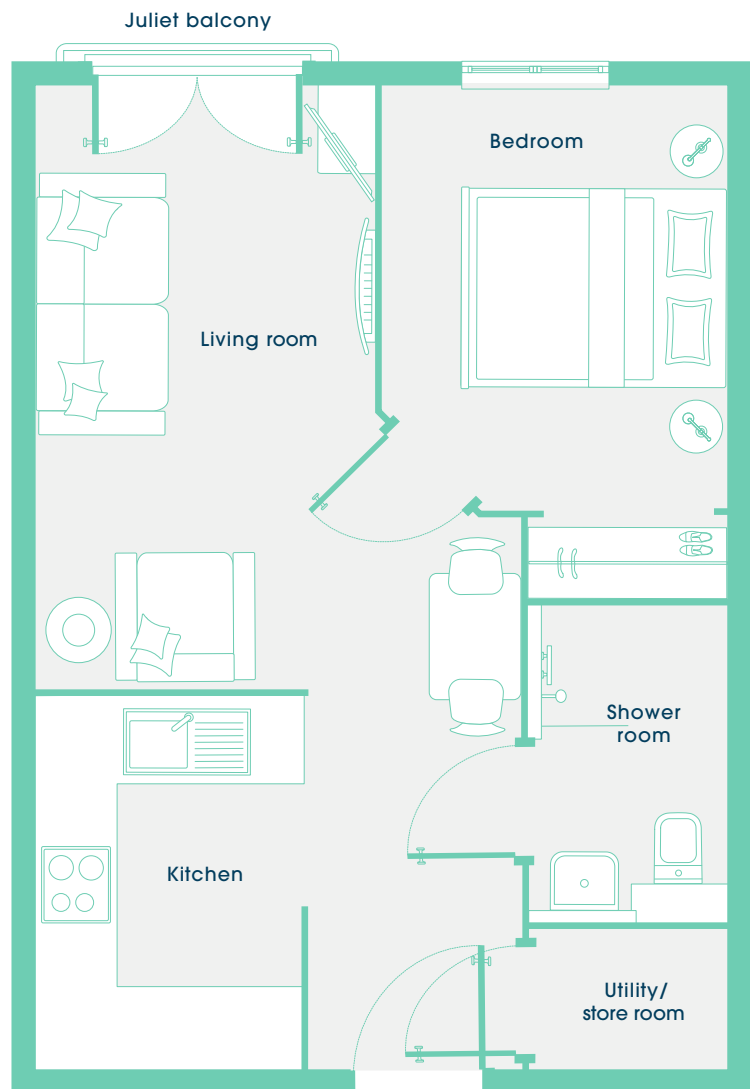

Dimensions: 36.60m² (394 ft²)

Kitchen	2.71m x 1.91m	(8'9" x 6'3")
Living room	4.40m x 2.49m	(14'4" x 8'2")
Bedroom	3.08m x 2.50m	(10'1" x 8'2")
Shower room	2.27m x 1.42m	(7'4" x 4'7")
Utility	1.00m x 1.43m	(3'3" x 4'7")

Version 2.0 February 2021

Please note, floor plans and dimensions are taken from architectural drawings and are for guidance only. Dimensions stated are within a tolerance of plus or minus 50mm. Overall dimensions are usually stated and there may be projections or reduced ceiling height into these. Please ask your Sales Advisor for specific details.



THE FOLDS
ROMILEY